

# INSTALLATION & CARE

## 2015-2017 FORD F150 PROJECTOR LED TWO-STYLE HEADLIGHTS INSTALLATION INSTRUCTIONS

### BEFORE INSTALLATION:

- If you experience any difficulties that the instructions did not cover, please seek assistance at a local automotive shop.
- Please wear proper protective equipment before you work on any vehicle.
- An assistant is recommended when removing the front bumper from your vehicle.
- Please be cautious when working with the bumper or any parts belonging to the vehicle's body to prevent scratching.
- Do not make direct contact with the halogen bulbs or the wire assembly until the unit has cooled down after use.

### TOOLS AND SUPPLIES REQUIRED

1/4" Ratchet	8 mm Socket	10 mm Socket	1/2" Socket
1/4" Socket Extension	Trim Pad Remover	Plastic Pry bar	

### PRODUCT NUMBER

2LHP-F15015-SQ-RS  
 2LHP-F15015JM-SQ-RS  
 2LHP-F15015BK-SQ-RS  
 2LHP-F15015G-SQ-RS

### LET'S START THE INSTALLATION



**STEP 1**

Remove the two 1/2" bolts



**STEP 2**

Remove the plastic fastener clip

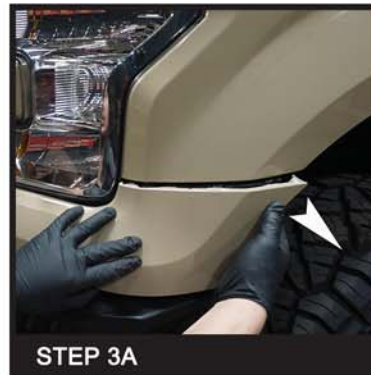

**STEP 3A**

Remove the headlight trim molding

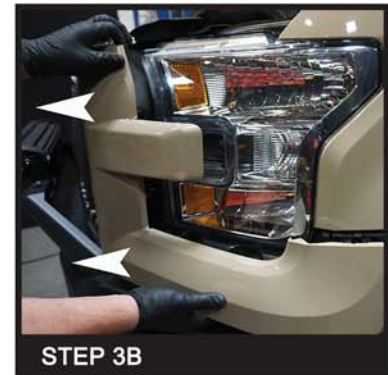

**STEP 3B**

Remove the headlight trim molding



**STEP 4**

Remove three 10mm bolts and one 8mm bolt at the front of the headlight trim support



**STEP 5**

Remove another three 10mm bolts at the side of the headlight trim support



**STEP 6**

Unclip the headlight trim support

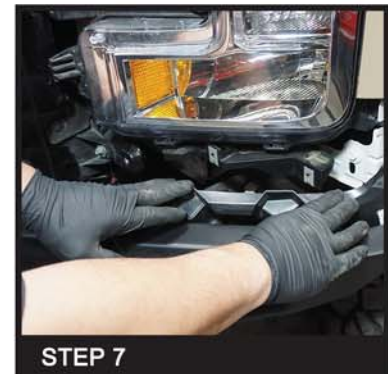

**STEP 7**

Push down the headlight trim support for more space





**STEP 8**

Remove the 10mm headlight mounting bolt at the side of the grille



**STEP 9**

Remove the two 10mm headlight mounting bolts at the top



**STEP 10**

Unseat the factory headlight housing



**STEP 11**

Disconnect the headlight harness and remove the factory headlight housing



**STEP 12**

Remove the parking light socket and the signal light socket from the OE headlight housing



**STEP 13**

Remove the light bulbs from the parking light socket and the signal light socket



**STEP 14A**

Install the signal light socket to the new headlight housing, (+) to (+) and (-) to (-)



**STEP 14B**

Install the signal light socket to the new headlight housing, (+) to (+) and (-) to (-)



**STEP 15A**

Install the parking light socket to the new headlight housing, (+) to (+) and (-) to (-)



**STEP 15B**

Install the parking light socket to the new headlight housing, (+) to (+) and (-) to (-)



**STEP 16**

Reconnect the headlight harness and seat the new headlight assembly in place



**STEP 17**

Reinstall the two 10mm headlight mounting bolts at the top



**STEP 18**

Reinstall the 10mm headlight mounting bolt at the side of the grille

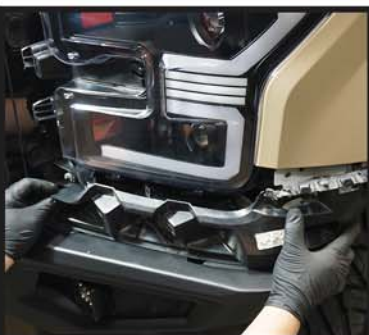

**STEP 19**

Reinstall the headlight trim support



**STEP 20**

Reinstall the three 10mm bolts on the side of the headlight trim support



**STEP 21**

Reinstall the three 10mm bolts and one 8mm bolt at the front of the headlight trim support





**STEP 22**

Reinstall the headlight trim molding



**STEP 23**

Reinstall the plastic fastener clip



**STEP 24**

Reinstall the two 1/2" bolts

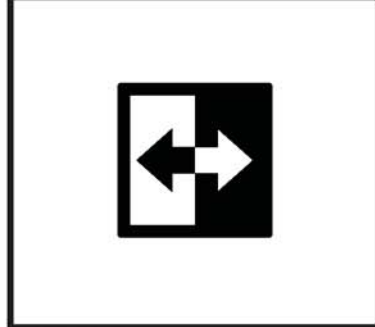

**STEP 25**

Please repeat the steps from 1 to 24 for the opposite side



**STEP 26**

Close the hood and complete the installation



## SEQUENTIAL SIGNAL CONTROL BUTTON INSTRUCTIONS



Style 1: Only the three light bars on center

Style 2: The light bar from top & bottom to center (Except the three light bars on center)

Press the button to change the Sequential style when the signal light is off