

INSTALLATION & CARE

2006-2008 MERCEDES-BENZ W164 ML-CLASS PROJECTOR HEADLIGHTS INSTALLATION INSTRUCTIONS

BEFORE INSTALLATION:

- If you experience any difficulties that the instructions did not cover, please seek assistance at a local automotive shop.
- Please wear proper protective equipment before you work on any vehicle.
- An assistant is recommended when removing the front bumper from your vehicle.
- Please be cautious when working with the bumper or any parts belonging to the vehicle's body to prevent scratching.
- Do not make direct contact with the halogen bulbs or the wire assembly until the unit has cooled down after use.

TOOLS AND SUPPLIES REQUIRED

| | | | |
|--|---|---|---|
| 1/4" Ratchet | 10 mm Socket | 10 mm Wrench | Flathead screwdriver |
|  |  |  |  |
| Trim Pad Remover | 1/4" Drive 6" Extension | 24 mm Wrench | 1/4" Drive T20 Torx Bit |
|  |  |  |  |
| | | | |
| | | | |
| | | | |

PRODUCT NUMBER

2LHP-BW16406-TM
2LHP-BW16406JM-TM

2LHP-BW16406BK-TM
2LHP-BW16406G-TM



LET'S START THE INSTALLATION



STEP 1

Remove the two 10mm bolts and two plastic fastener clips at the top of the front grille

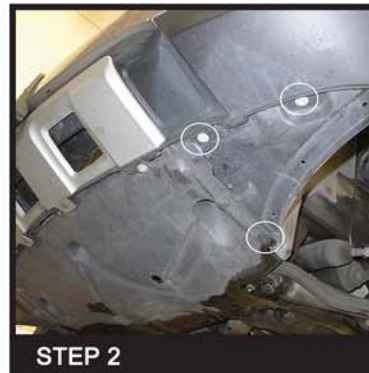

STEP 2

Remove the three wheel well liner 10mm bolts underneath the front bumper



STEP 3

Remove the two wheel well liner 10mm nuts

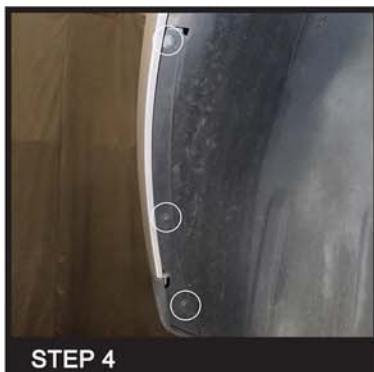

STEP 4

Remove the three fasteners and then loosen the wheel well liner



STEP 5

Remove the T20 bolt on the bumper end bracket



STEP 6

Use a flat head screwdriver to remove the bumper end bracket



STEP 7

Remove the 10mm lower headlight mounting bolt



STEP 8

Remove the 10mm headlight mounting bolt on the top of the headlight



STEP 9

Gently pull out the front bumper a little bit for more space to remove the factory headlight housing



STEP 10

Unseat the factory headlight housing



STEP 11

Disconnect the headlight harnesses and the light sockets



STEP 12

Remove the two T10 light bulbs from the parking light and the signal light socket



STEP 13A

Use a 24mm wrench to remove two mounting adjusting nuts from the factory headlight housing and reinstall to the new headlight housing



STEP 13B

Use a 24mm wrench to remove two mounting adjusting nuts from the factory headlight housing and reinstall to the new headlight housing



STEP 14

Remove the headlight seal ring from the factory headlight housing and reinstall to the new headlight housing



STEP 15

Use alcohol to clean the metal surface to apply the resistor



STEP 16A

Set the T10 signal light resistor on the metal area



STEP 16B

Set the T10 signal light resistor on the metal area



STEP 17

Install the T10 signal light resistor to the signal light socket (the gray socket with amber bulbs), + to + and - to -



STEP 18

Set the other two resistors on the metal area



STEP 19

Connect the wire harness and resistor, also connect the T10 plug to the parking light socket (black socket with clear bulbs), + to + and - to -



STEP 20

Seat the new headlight assembly in place



STEP 21

Reinstall the front bumper



STEP 22

Reinstall the 10mm headlight mounting bolt on the top of the headlight



STEP 23

Reinstall the 10mm lower headlight mounting bolt



STEP 24

Reinstall the bumper end bracket



STEP 25

Reinstall the T20 bolt on the bumper end bracket

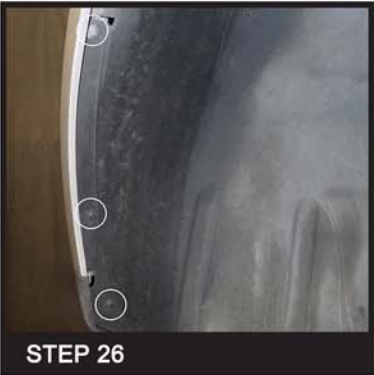

STEP 26

Reinstall the three fasteners for the wheel well liner

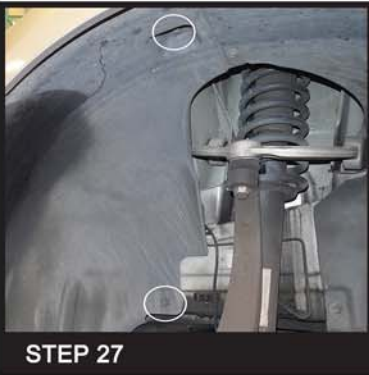

STEP 27

Reinstall the two wheel well liner 10mm nuts

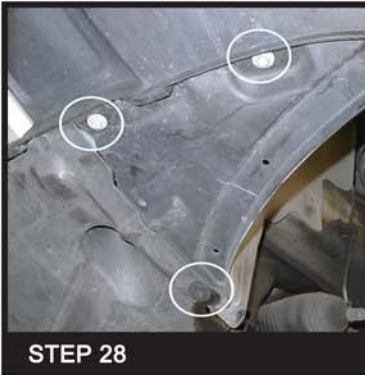

STEP 28

Reinstall the three wheel well liner 10mm bolts underneath the front bumper



STEP 29

Please repeat the steps from 2 to 28 for the opposite side



STEP 30

Reinstall the two 10mm bolts and two plastic fastener clips at the top of the front grille

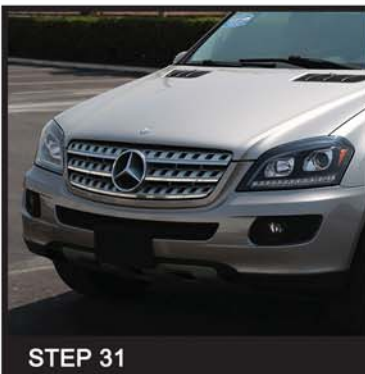

STEP 31

Close the hood to complete the installation



INSTALLATION & CARE

2006-2008 MERCEDES-BENZ W164 ML-CLASS PROJECTOR HEADLIGHTS INSTALLATION INSTRUCTIONS

BEFORE INSTALLATION:

- If you experience any difficulties that the instructions did not cover, please seek assistance at a local automotive shop.
- Please wear proper protective equipment before you work on any vehicle.
- An assistant is recommended when removing the front bumper from your vehicle.
- Please be cautious when working with the bumper or any parts belonging to the vehicle's body to prevent scratching.
- Do not make direct contact with the halogen bulbs or the wire assembly until the unit has cooled down after use.

2006-2008 MERCEDES-BENZ W164 ML-CLASS PROJECTOR HEADLIGHTS INSTALLATION INSTRUCTIONS

